

OTHER USES FOR THE COMMUNITY BUILDING

Sub—Branch Library

West Riding County Library set up a sub branch library in the community centre during the war. It occupied one small corner of the building and was probably under the jurisdiction of Earby library and open on a part time basis.

Tenancy agreement drawn up between Earby UDC and West Riding County Library Service 1st November 1957. A 7 year tenancy initially at £20 per annum rent. The first payment to be made to the

A fluctuating population has made a difference to the use of the branch. The changeover to the Community Centre premises which took place in the autumn has not proved to be satisfactory. Various domestic difficulties notably the lack of a cleaner, the sharing of the room with other bodies, some of whom make havoc of the bookshelves, and the difficulty of entering the building in time to start the library session, have all interfered with the smooth running of the Branch. It is hoped however that these difficulties will be overcome in the near future.

27th October 1945 – Letter stating that he Northholme Centre librarian, Mrs M.E. Newman has resigned as her husband was leaving the district.

Statistics of books borrowed – 1st April 1945 to 31st March 1946
Fiction 2760
Junior Fiction 630

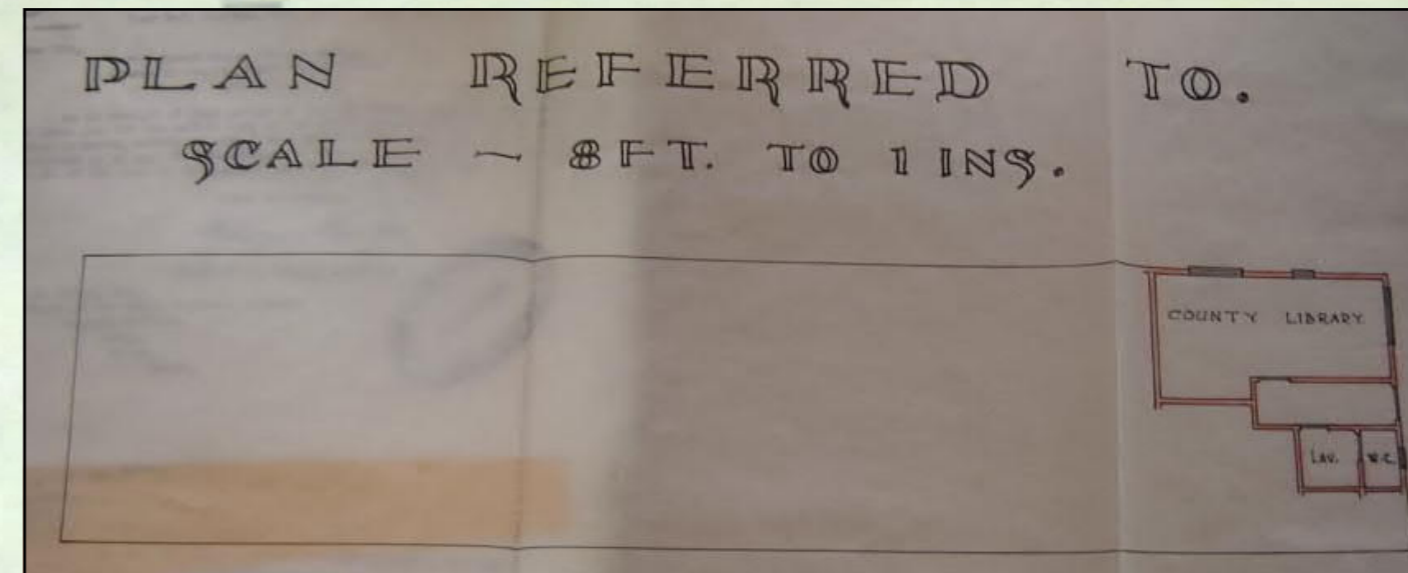

Plan from 1957 Tenancy Agreement Showing the Position of the Library

EGG PACKING STATION (DALES FARM EGGS)

Head Line on Craven Herald Article 3rd May 1963

EARBY EGGS ENTERPRISE
Well Equipped Firm with a Forward Look
Collecting, Grading, Packing, Distributing;
Protecting the consumer

Gordon Jackson and co-directors Mr John Cockshott and Mr J C Black set up Dalesfarm Egg Packing Station in the old community centre, A loading bay extension was added to the building. Initially the library continued to operate.

Jackson had been concerned with poultry all his working life. He ran a farm at Toppam House, Cracoe, in partnership with his father, and worked there since leaving school. Pressure of business forced him to relinquish positions he had held with the National Farmers' Union, but he was still in sympathy with their aims and objects.

Dalesfarm eggs began production in Earby in December 1961 and by 1963 had 25 employees. The business began at a time when intensive chicken rearing and egg production were developing giving a more consistent supply of eggs than was possible by free range rearing. With larger flocks, "cycles" of laying all the year round were possible with continuity of production and all year round production led to more stable prices.

The company had modest beginnings but by 1963 they had 6 vehicles travelling through Yorkshire and East Lancashire collecting thousands of eggs. Modern equipment was installed for grading and quality control and eggs not meeting the required standard were liquidised, frozen and supplied to bakery firms.

The eggs went through "candling", a process where by the egg is examined in a beam of intense light to show up deformities, impurities and to detect hairline cracks in the shell; the eggs were weighed to grade large, standard, medium, small and extra small. The eggs were then packed into the familiar egg boxes.

Egg marketing Board Inspectors did regular checks on production to ensure standards were maintained.



The Section of the Building used for the egg packing station with loading facility extension to the front

OVALTINE LINK

Dalesfarm Eggs Ltd., was also an Ovaltine franchise packing station, and some of the eggs dealt with were marketed under the Ovaltine brand, and others under Dalesfarm.

"By being associated with this nationally known and highly respected organisation, and being the only firm in Yorkshire to be in our position, we are able to get many advantages for ourselves and, more particularly our customers" quoted Jackson.

"We are able to draw on their vast technical knowledge and skill; we reap the benefits of their extensive research; we benefit from their block scheme on appliances and from their hire purchase facilities."

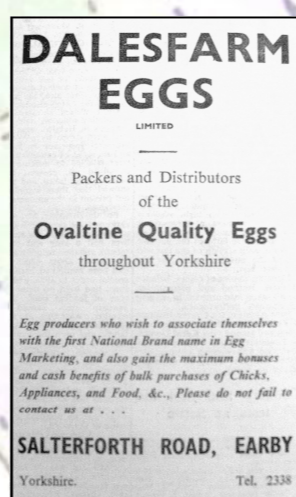

Egg Marketing Board marketing material—the Lion brand eggs and Tony Hancock in a "Go to Work on and Egg television advert from the 1960s



Egg packing Station Fire 28th April 1964
Craven Herald Headline
Fire on Earby Egg Station; Stock and Buildings Suffer

The fire was discovered at about 1-00am on Tuesday morning.

Firemen from both Earby and Barnoldswick were soon on the scene and were able to confine the blaze and stop it spreading the whole length of the building up to the library. One of the biggest dangers was that the fire would spread to a diesel oil storage tank but fortunately this was averted.

Mr Leslie Parking of Warwick Drive was one of the first to raise the alarm
"I heard a bang, looked out of the bedroom window and saw part of the roof going in"

Mr Roin Smith, returning from shift work in Gargrave arrived home at about 1-10am and stated,
"At the time there was nothing. The wind was blowing down to our house and I am sure if there had been any smouldering I would have smelled it. Then 10 minutes later I heard crackling and flames were already shooting through the roof."

The office was completely gutted and part of the grading room roof fell in and damage was estimated to run into the thousand of pounds. Fortunately the grading machines themselves were not badly damaged and it was hoped that with rewiring they could be running again within a few days.

Most of the 20 workers were cleaning up the debris later that day.



Council Usage

The building was only leased by Dalesfarm Eggs from Earby Urban District Council and when the egg packing station closed the vacated premises were used by the council themselves for storing equipment and for baling recycled waste paper